

InLab[®] Easy BNC

pH Ref °C ISM

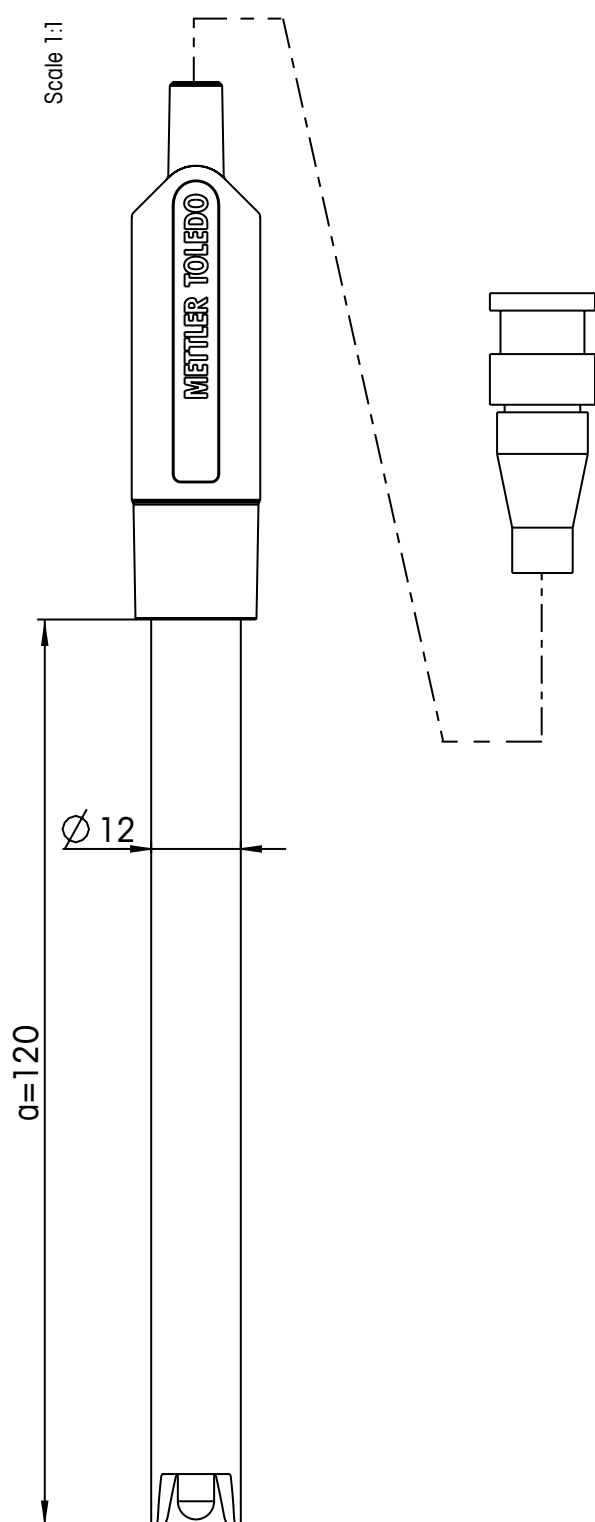

For general applications in the lab and outdoor;
maintenance-free



Sensor type combined pH electrode

Order number 51343011

Specifications

pH range 0...14

zero point (pH) 7.00 ± 0.25

temperature range 0...80 °C

temperature probe -

shaft material polysulfone

membrane glass U

membrane resistance < 250 MΩ

reference system ARGENTHAL™

reference diaphragm ceramic

reference electrolyte gel

bridge electrolyte -

electrode head -

cable length 1.2 m

connector BNC

cell constant (cm⁻¹) -

cell type -

indicating metal -

Storage

InLab storage solution (30111142)

or 3 mol/L KCl (51350072)